

Scrub Sinks

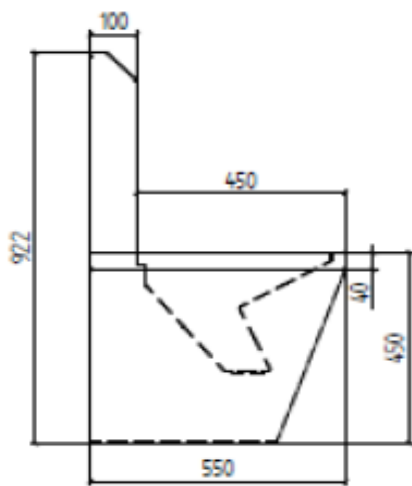

Description:

Transforma provides a range of hospital specialized scrub sinks with anti-splash and anti-stacking fluid tank design. The sinks are produced in three different standard sizes and two different material finishes to satisfy the requirements of the clients; the possibility of customization is also available when needed.

Available Options	
Dimensions	<ul style="list-style-type: none"> - 1 Wash Basin: 700 x 550 x 922 mm - 2 Wash Basin: 1,400 x 550 x 922 mm - 3 Wash Basin: 2,100 x 550 x 922 mm

Technical Data	
Sink Material finish	<ul style="list-style-type: none"> - Stainless Steel AISI 304 - Solid Mineral Surface (SMS) with a range of colors to be selected from the standard color card
*Electronic Tap Details (in a single set)	Electronic tap; chrome plated surface finish
	Electronic soap dispenser with LED soap level indication
	Thermostatic mixer with water temperature control
	Hydraulic made in full brass with smooth surfaces; to reduce risk of bacterial growth
	Outer plate made in Stainless Steel AISI 304; to avoid any reactions with environment
	220 V, 50/60 Hz with 18 Vac safety transformer approved by IMQ
Origin	Italy

*Manual tap and mixer available as an option

Certifications & Standards:

- Electronic tap: CE marked