

Integrated Storage Cabinets

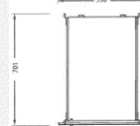
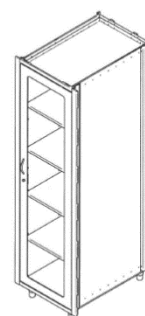
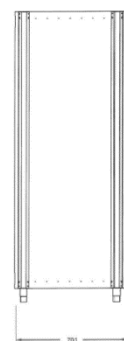
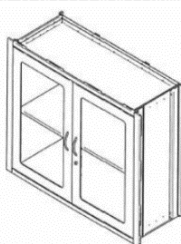
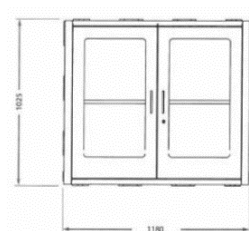

Description:

Transforma Healthcare offers a range of Operation theater storage cabinets, tailored for the specific needs of clients; standard cabinet sizes are available alongside the ability to adjust and tailor shape and size of the cabinets.

Transforma is generally offering “single door” and “double door” flush mounted cabinet solutions with a variation in size and capacity.

Transforma has selected to realize the storage cabinets using Stainless Steel AISI 304 material that is anti-corrosive and capable of handling the rigorous hygiene detergents used in Operation Rooms.

The cabinets can be produced with scotch-brite fine finishing or any RAL colored antimicrobial powder coating, selected to the preference of the client.

Standard Cabinets	
Double Door Full Height Storage cabinet	Width: 1180 mm Depth: 450 mm Height: 2,150 mm Shelves: 4
Single Door Full Height Storage cabinet	Width: 590 mm Depth: 701 mm Height: 2,050 mm Shelves: 4
Double Door Half Height Storage Cabinet	Width: 1180 mm Depth: 450 mm Height: 1,025 mm Shelves: 1
Catgut Cabinet	Width: 800 mm Depth: 450 mm Height: 500 mm Shelves: 1

Technical Data	
Cabinets Material Finish	<p>Body and doors made in Stainless Steel AISI 304:</p> <ul style="list-style-type: none"> - Scotch Brite finish (Standard) - RAL Color for the door frames; from the standard colors card <p>Doors also have 3 mm stratified glass viewing window(s)</p>

Anti- dust Sealing	A silicone rubber gasket is placed on the doors from inside the cabinet to ensure sealed closing
Shelving options	<ul style="list-style-type: none"> - Stainless Steel AISI 304 (Standard); seamless shelves - Glass
Installation Method	<ul style="list-style-type: none"> - Cabinets modularity fit with the Transforma modular wall system in a flush mounted assembly - Exposed type cabinets
Lock(s)	Key locking mechanisms are available when needed
Origin	Italy